

Zas

Model Ref. 51440

Description: Single-lever lavatory faucet with pop-up waste

Material: Solid brass

Finish: Polished chrome

Dimensions: 6-7/8" H x 4-5/8" Spout Projection x 3-3/8" Aerator Clearance

Features:

- Solid brass construction according to EN 12164
- High quality finishing
- Ø40 mm Ceramic disc cartridge
- 2GPM water conservation aerator
- Pop-up waste Ø2-7/16" drain Dome x G1-1/4" connection
- Ø1-7/8" mounting ring
- Flexible stainless steel water supply tubes approved by UNE 53-626/2



Technical Specifications:

- Max water temperature: 90° C
- Opening max angle: 25°
- Movement max angle: 90°
- Water flow rate as per aerator options are available (from 0.50 GPM to 2GPM)
- Ceramic disc: Al₂O₃ 96%
- Resistance test: Min 70000 circles as per EN 817

Approvals:

- EN 817
- DIN 4109
- NF-D18.202
- CSA B 125-93
- ASME A 112.18.1
- KIWA BRL-K607/01 1990

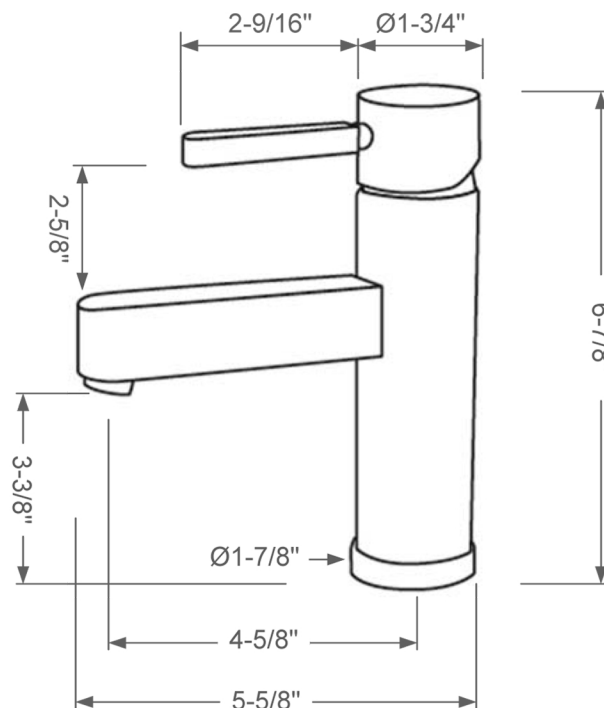

GlassArtistsGallery.com | SinksGallery.com | ArtisanCraftedLighting.com | WoodArtistsGallery.com | CustomFurnitureOnline.com

Info@ArtisanCrafted.com

Toll Free: 1.877.320.0800 | Fax: 360.321.2585 | PO Box 1030 | Langley, WA 98260