

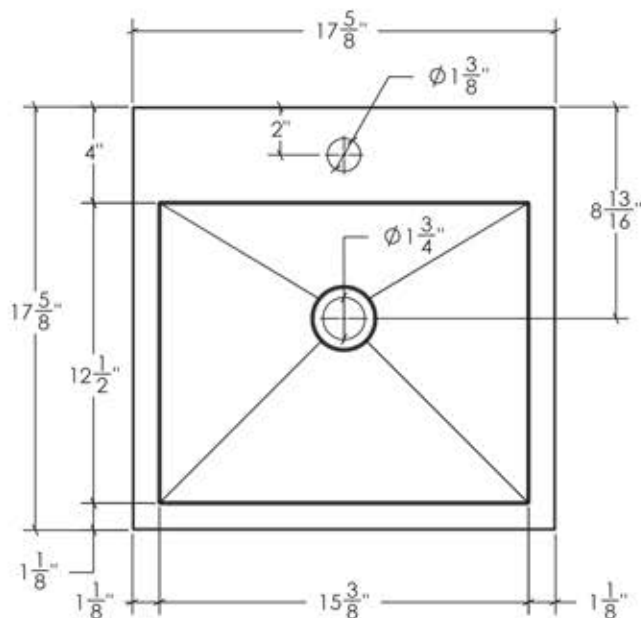

MS-005

FEATURES:

- * Sink Size: 17-5/8" x 17-5/8" x 4-7/8"
- * Material: 18 Gauge Stainless Steel
- * Wall-hung / Above Counter Sink
- * Recommended Drain: DS-003B
- * Pre-drilled Hole For Faucet
- * For Use With Standard Pop Up Drain
- * Warranty: One Year Limited Warranty



TOP VIEW

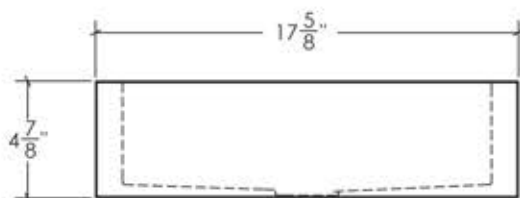

FRONT VIEW

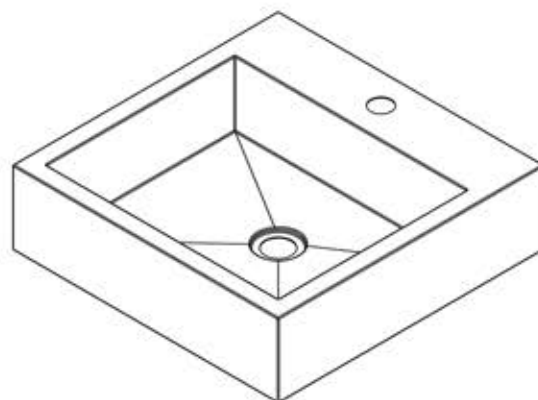

3D VIEW

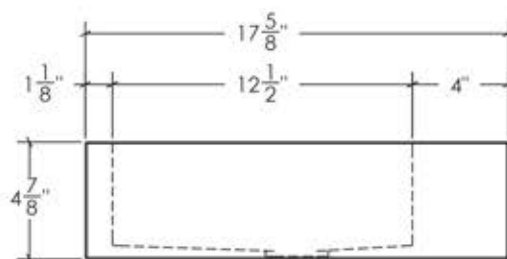

SIDE VIEW

JOB INFORMATION:

Job Name _____

Date Specified _____

Contractor _____